



e - NOC

No.

E 000662

KOLKATA METROPOLITAN DEVELOPMENT AUTHORITY

Housing Sector
Unnayan Bhawan, 1st Floor, DJ – 11, Sector – II,
Salt Lake, Kolkata – 700091.

No. 2E / KMDA / EoDB/ 2022/ 314

Dated : 16.05.2022

Sri/Smt. JAGANNATH CHANDA & 4 OTHERS

M/S J. D. S. CONSTRUCTION

82A, Ibrahimapore Road,

P.S. & P.O.– Jadavpur,

Kolkata – 700 032.

Re. :- Premises No. 82A, IBRAHIMPORE ROAD,
Ward No.- 096,
Borough No.- X,
Kolkata – 700 032.

Dear Sir / Madam,

In connection with Plan Case No. 2022100031 applied on dated 19.04.2022 for K.M.C. Assessee No. 210960202867 I have to inform you that the site / building plan submitted with your application has been examined with erstwhile Trust Plan / Records. Accordingly, the above property is not affected at present by any published / sanctioned Scheme of the erstwhile Trust.

The above observation must be read with the copy of the site plan which is returned herewith duly endorsed. The correctness of the site plan is not verified / certified.

Further, the letter should be treated as invalid or cancelled if any overwriting, erasing or any kind of disfiguration is made either on this letter or on the enclosed site plan.

Yours faithfully,

Mrishant Chandra

Executive Engineer,
Housing Sector, K. M. D. A.

17/5/2022

EXECUTIVE ENGINEER
KMDA, HOUSING SECTOR

Enclo. : Copy of endorsed site plan in .pdf format showing
Land Area mentioned in Boundary Declaration.

SITE PLAN AND LOCATION PLAN OF PREMISES NO. - 82A, IBRAHIMPUR ROAD, P. S. JADAVPUR, WARD NO. 096, KOLKATA 700 032 UNDER BOROUGH -X, FOR KMDA NOC U/S 393(A) OF K.M.C. ACT B/R 2009

LAND AREA = 5 K - 15 CH - 23 SFT = 399.294 SQM (AS PER DECL. IN B/D)

ASSESE NO.: 210960202867 PLAN CASE NO. 2022100031

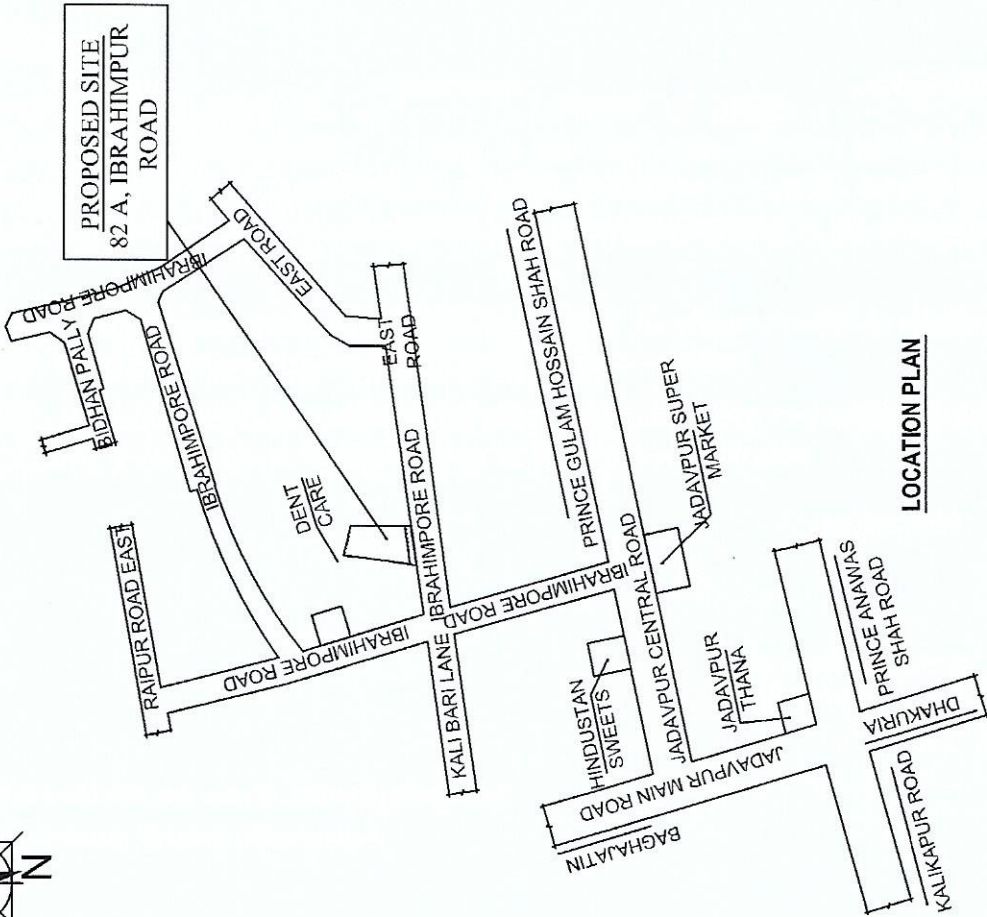
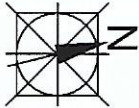

LOCATION PLAN

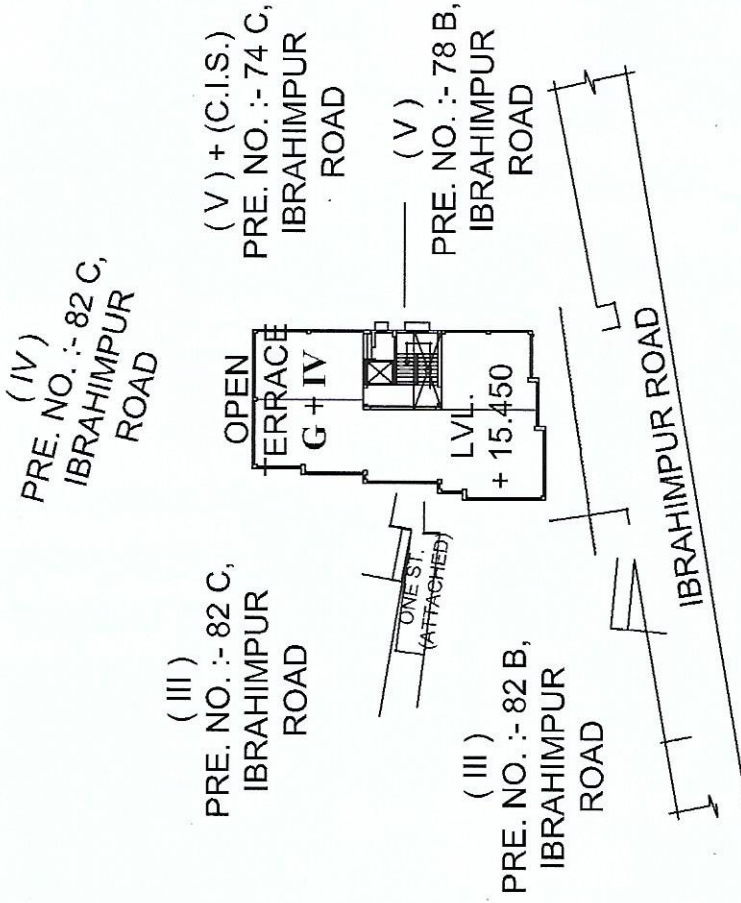

SITE PLAN.

These observations are hereby given as per Sub-Rule (8) of Rule (4) of the K.M.C. Building Rule 1990
 This plan was enclosed with Party's applications.
 The Correctness of the plan is not verified / certified.
 Enclosure to the letter No. 2E/KMDA/EoDB / 2022/314

Krishanu Choudhury
 EXECUTIVE ENGINEER
 KMDA, HOUSING SECTOR

Executive Engineer
 Housing sector
 Kolkata Metropolitan Development Authority

NOTE :
 This plan is not to the scale and has been prepared on the basis of Building Plan submitted by the Applicant in .dvg format through CAF against Plan case No. 2022100031 dated 19.04.2022

17/5/22